

RG005-0105-0*-EGE0

- 1 : OUTPUT FORM RS-422 , WITH USB
- 2 : OUTPUT FORM RS-422 , WITHOUT USB

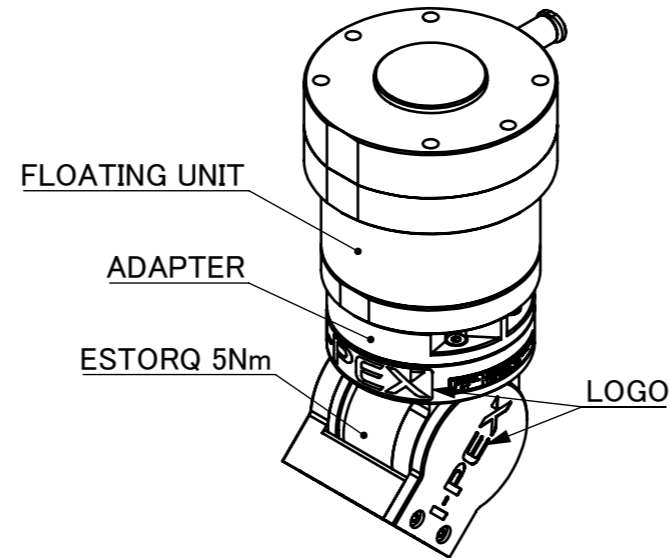

< RANGE OF MOTION >

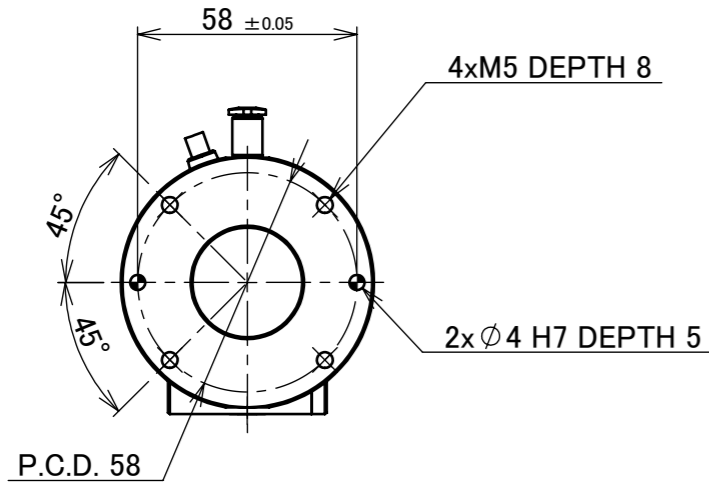
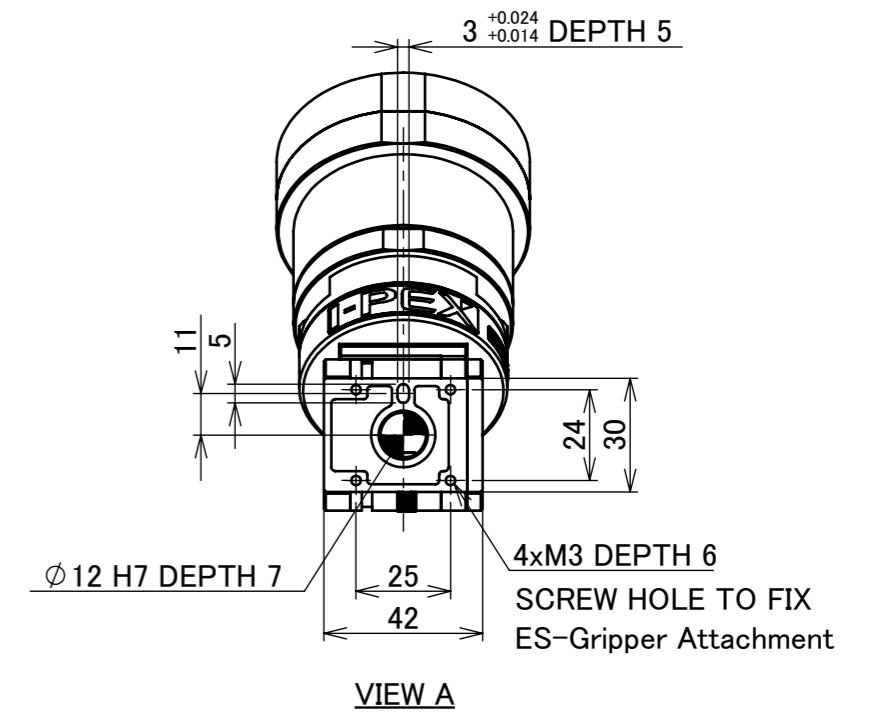
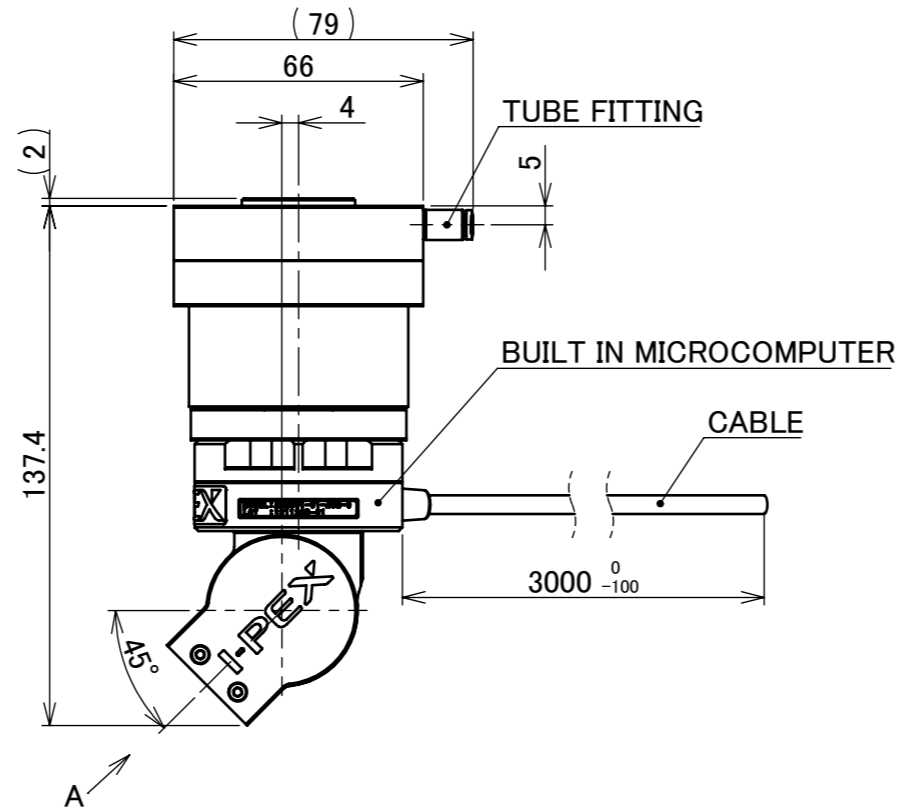
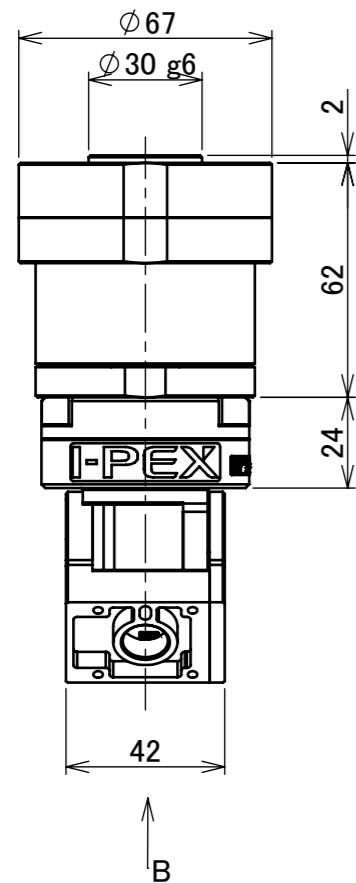
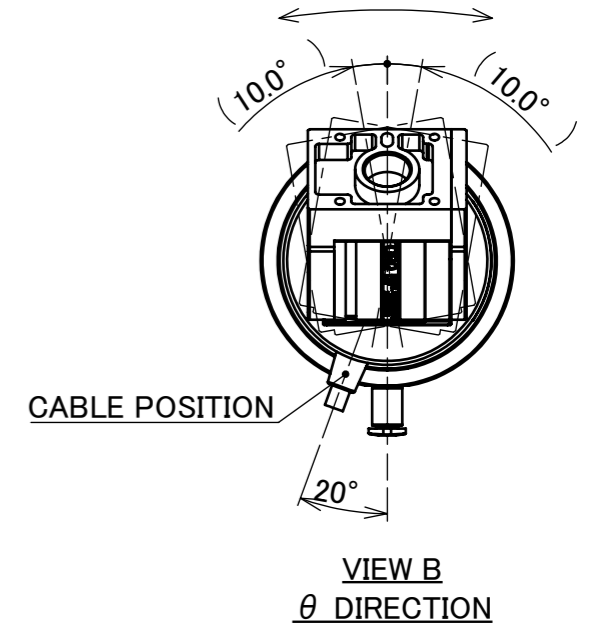
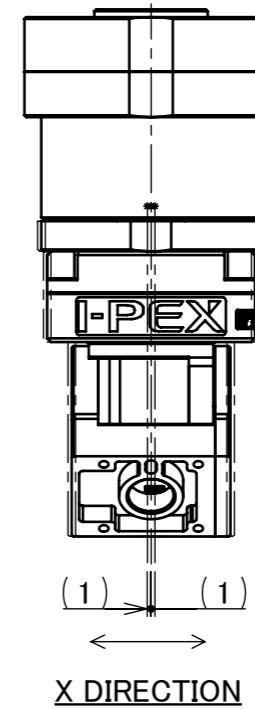

- NOTES.
1. MATERIAL
FRAMEWORK : ALUMINIUM
 2. WEIGHT : ABOUT 905 g
 3. ES-Gripper Body USES MAGNETIC PARTS.

					ANGLE	±2°	6 OVER 30 MAX.	±0.3	PROJECTION	SERIES No.	CUSTOMER COPY
					6 MAX.	±0.2	30 OVER 120 MAX.	±0.5			
					GENERAL TOLERANCE.			120 OVER 400 MAX.	±0.8	ES-GRIPPER® BODY FINE X+θ TYPE	SCALE
					DWG.	H.Tagomori	DATE	2023/08/01	UNIT		I-PEX
					CHK.	A.Kuromaru	DATE	2023/08/01	mm		
					REV.	DATE	DWG.	CHK.	APP.	DWG. No.	SIZE
					0	Aug./01/'23	H.T			RG005-0105-0*-EGE0	A3
					REVISION RECORD			T.Hara	DATE	2023/08/01	SHEET
											1/1
											REV.
											0

I-PEX Inc.

Confidential C